

PRODUCT DESCRIPTION

PVC Single and Double 45 degree Chamfers in 0.5" and 0.75" heights feature Flex Edge Seal which reduces seepage of concrete under the product.

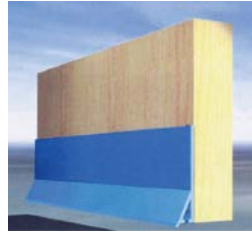

APPLICATION

Chamfers are used for the face edge of the wall panels to eliminate edge breakage at the panel face and ease in application of caulking of the panel joint.

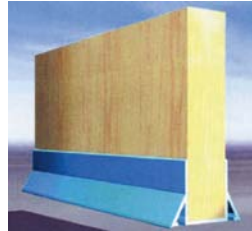

FEATURES:

- 100% PVC Reduces Costs—PVC virtually eliminates concrete pitting caused by wood-wicking. It also eliminates discoloration caused by wood sugars. It almost entirely eliminates the need for grinding and patching, saving you man-hours or subcontractor expense.
- Patented "Flexible Edge Seal"—The patented Flexible Edge Seal fits tightly against the casting surface, preventing concrete seepage while creating sharp, crisp lines.
- Hidden Fastening System—With Victory Bear there are no finish blemishes from screw heads or excess glue. All screws and glue remnants are hidden under the surface for a sharp, glass-like finish.
- 60 Degree Angles—Tighter angles create sharper shadow lines, casting the illusion of deeper reveal strips and improving the overall aesthetics of your building.
- Double Chamfer—Designed to accept ¾ inch plywood or standard one inch lumber, allowing you greater flexibility in your lumber choice.
- Single Chamfer—Attach directly to the face of the form board by nailing through the vertical nailing plate, keeping the chamfer free of blemishes.

INSTALLATION

Step 1—Fasten the chamfers in place using fastener, tape or adhesive.

Step 2—Check to ensure that the chamfer's edge is pressed firmly against the casting surface.

Step 3—For double chamfer, insert lumber along the length. For wood that is swollen beyond standard

dimensions, insert one side first against the Flex Edge Seal, then roll the other side into the channel.

Step 4—For single chamfer, align chamfer along the form and casting surface. Press firmly against both and staple or nail into place. Nail guns are NOT recommended.

Hanging Single Chamfer

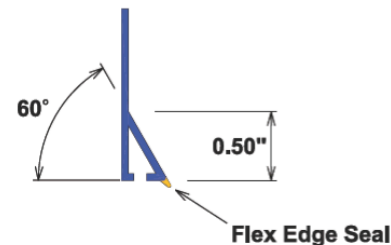

Double Chamfer

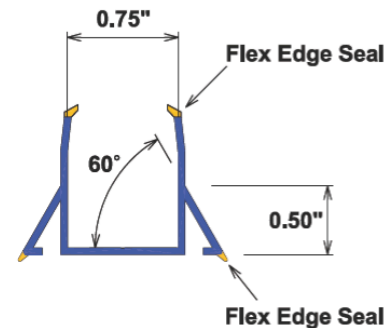

TECHNICAL DATA

- Material: PVC
- Length: 8'-0" each
- Coefficient of linear expansion: 0.0132 inches per degree F
- Color: White or Grey Tone

PACKAGING

- Quantity: 60 pieces per box
- Weight: 27.8 lbs per box

PRODUCT CODES

- 128708 Single Chamfer $\frac{1}{2}$ " x 60 degree # 754
- 128707 Double Chamfer $\frac{1}{2}$ " x 1" 60 degree #755

HOW TO ORDER

Specify: (1) quantity, (2) Product Code, (3) name.

STORAGE

Materials should be stored out of direct sunlight to prevent long-term deterioration or color fading. Pieces can be stacked, but should be stored fully supported to keep them from warping.

WARRANTY

Dayton Superior warrants the product will be free from defects in material and workmanship. The foregoing warranty is in lieu of and excludes all other warranties not expressly set forth herein, whether express or implied by operation of law or otherwise, including but not limited to any implied warranties of merchantability or fitness.

Dayton Superior shall not be liable for incidental or consequential losses, damages or expenses directly or indirectly arising from the sale, handling or use of the product or from any other cause relating thereto. Seller's liability hereunder is expressly limited to replacement, in the form originally shipped, of goods not complying with this agreement or at Dayton Superior's election, a refund equal to the purchase price of the product.

Specifications and other information contained herein supersede all previously printed matter and are subject to change without notice.

TECHNICAL SERVICES

Dayton Superior's trained sales staff is available for consultation on all aspects of technical and design support, please call 888-977-9600.