

TECHNICAL DATA SHEET

**DESCRIPTION**

The PHC Hy-Chair consists of a molded composite base and a upper wire wicket insert.

**APPLICATION**

PHC is used in application requiring the chair to straddle the lower rebar mat and provide cover heights above 10".

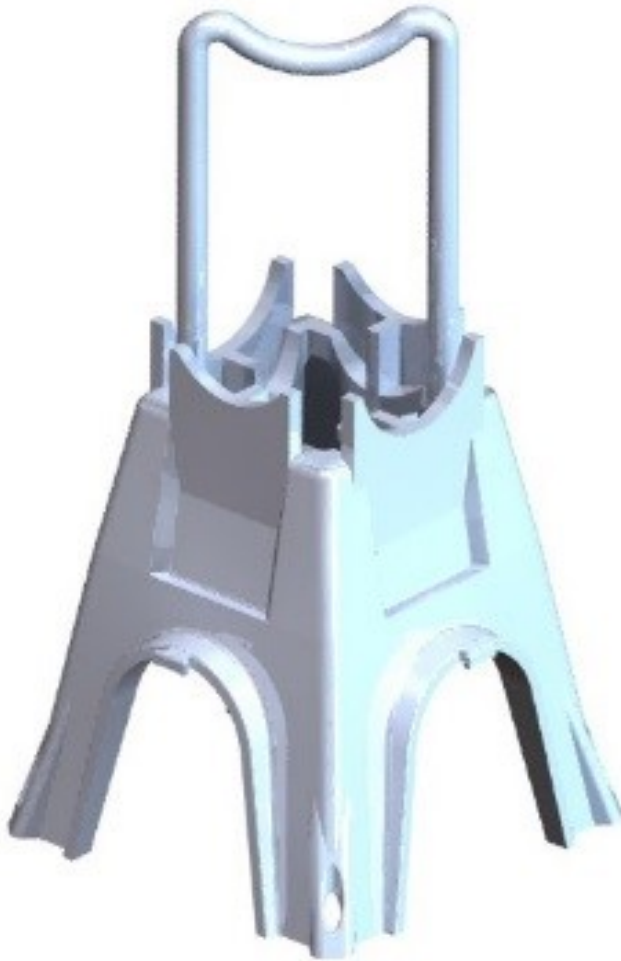

**FEATURES**

- Provides superior strength
- Supports loads up to 500 lbs
- Clearance Heights up to 14"
- Straddles lower rebar mats up to 2-3/4"
- Pre-assembled prior to packaging
- Plastic base insures minimal footprint
- Eliminates Corrosion on exposed surfaces
- Meets all requirements to qualify as a CRSI Class 1 Bar Support

**Technical Data**

PRODUCT CODE	COVER	QTY / BOX	WT. LBS. PER BOX
220352	10-1/4"	75	39
220353	10-1/2"	75	41
220354	10-3/4"	75	42
220355	11"	50	43
220356	11-1/4"	50	28
220357	11-1/2"	50	28
220358	11-3/4"	50	30
220359	12"	50	27
220360	12-1/4"	50	30
220361	12-1/2"	50	30
220362	12-3/4"	50	32
220363	13"	50	31
220364	13-1/4"	50	33
220365	13-1/2"	50	32
220366	13-3/4"	50	33
220367	14"	30	25

**INSTALLATION**

1. Per CRSI published guidelines

**RELATED PRODUCTS**

- Aztec®PTC Tower Chair™
- Aztec®Straddle Chair™
- Aztec®Tower Chair Sand Plate™
- Aztec®Straddle Chair Sand Plate™

**ORDERING INFORMATION**

Product Code	Description	Weight
220352	10-1/4"	0.577 LB
220353	10-1/2"	0.5814 LB
220354	10-3/4"	0.588 LB
220355	11"	0.6119 LB
220356	11-1/4"	0.6295 LB
220357	11-1/2"	0.6405 LB
220358	11-3/4"	0.6449 LB
220359	12"	0.6537 LB
220360	12-1/4"	0.6625 LB
220361	12-1/2"	0.6691 LB
220362	12-3/4"	0.6779 LB
220363	13"	0.6889 LB
220364	13-1/4"	0.6955 LB
220365	13-1/2"	0.7065 LB
220366	13-3/4"	0.75 LB
220367	14"	0.7676 LB

## TECHNICAL DATA SHEET

**MANUFACTURER**

Dayton Superior Corporation  
1125 Byers Road  
Miamisburg, OH 45342  
Customer Service: 888-977-9600  
Technical Services: 877-266-7732  
Website: [www.daytonsuperior.com](http://www.daytonsuperior.com)

**WARRANTY (ACCESSORIES)**

Limited Warranty. Dayton warrants, for a period of 60 days from the date of shipment (three years from the date of shipment in the case of formwork, excluding any consumable Products included with such formwork), that Products and any associated application drawings and engineering services provided by Dayton ("Ancillary Services") will be free from defects in material and workmanship and, in the case of custom designed formwork, that the formwork will meet the specifications set forth in the design drawings approved by Dayton and Customer. Any claim under this warranty must be made in writing within such warranty period. If any Product and/or Ancillary Service covered by a timely claim are found to be defective, Dayton will, within a reasonable time, make any necessary repairs or corrections or, at Dayton's option, replace the Product. Unless pre-authorized by Dayton in writing, Dayton will not accept any charges for correcting defects or accept the return of any Product. This warranty will not apply to any Products that have been subjected to misuse, neglect, storage damage, misapplication, accident or any other damage caused by any person other than Dayton, or that have not been maintained in accordance with Dayton's specifications. THIS LIMITED WARRANTY IS IN LIEU OF ALL OTHER WARRANTIES AS TO THE PRODUCTS AND ANCILLARY SERVICES. DAYTON MAKES NO OTHER WARRANTIES OR GUARANTEES, EXPRESS OR IMPLIED, INCLUDING ANY WARRANTY OF MERCHANTABILITY, FITNESS FOR A PARTICULAR PURPOSE OR OTHERWISE. THE REMEDIES SET FORTH IN THIS SECTION ARE CUSTOMER'S EXCLUSIVE REMEDY FOR BREACH OF WARRANTY.