

T72 ROOF NAILER ANCHOR

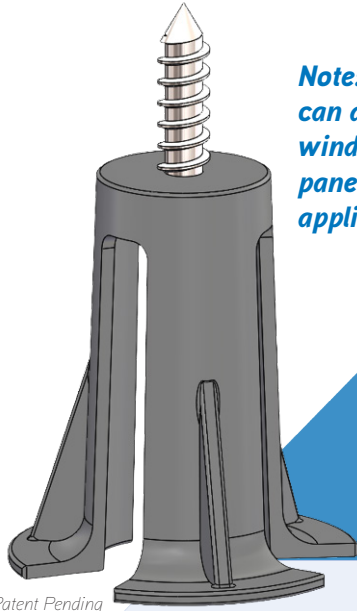

Note: the T72 nailer anchor can also be used with window and door panel attachment applications.

Patent Pending

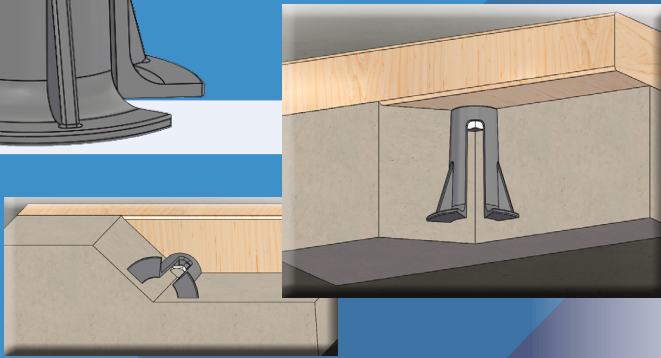

- Easy & fast installation with "Grab 'N Go" drill process
- No handling of multiple components
- Discrete gray color, lightweight, and easy to handle

The T72 Roof Nailer Anchor is a small, discrete anchor which allows for QUICK INSTALLATION and EASIER CONCRETE CONSOLIDATION

*Tired of disrupted roof flashing and dealing with large lag/anchor bolts?
The T72 Roof Nailer allows for quick and verifiable installation on-site.*

FEATURES

- Self-tapping lag screw
- Non-corrosive & high-strength plastic material
- One size for all tilt applications
- Roof Nailer Cone and Lag Screw is one cohesive unit
- Slotted three leg design allows concrete flow and consolidation around the anchor
- 750 lbs. Ultimate Load Capacity Connection (*test reports available upon request*)

Mitigate issues for potential water intrusion areas, the T72 installs within the panel prior to casting - eliminating the need to countersink or penetrate the top of your PT lumber.

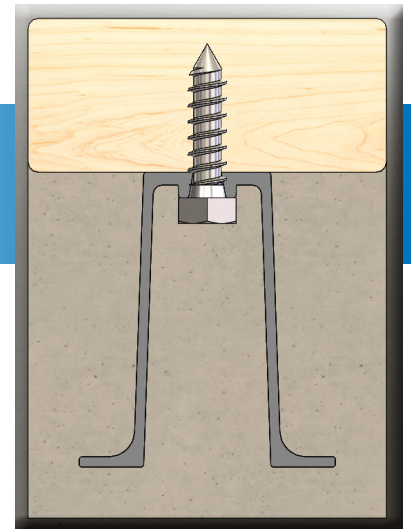

Note: The lag screw does not rotate independently of the cone, the T72 is one, assembled unit.



LEARN MORE

DAYTONSUPERIOR.COM | 800-977-9600



©2024 Dayton Superior Corporation