



DAYTON[®]
SUPERIOR



- Rebar sizes #4 [13mm] through #18 [57mm]
- For use with Grade 60, 75 & 80 rebar
- Type 2 Splice per ACI 318-19

D390 TAPER-LOCK[®] GROUT SLEEVE

- **VERSATILE TO MEET PROJECT NEEDS**
- *Forgiving grouted connection allows for misaligned and reduced embedment bars*
- *Complies with most building codes and jobsite specifications*

The D390 Taper-Lock[®] Grout Sleeve is used to MECHANICALLY SPLICE TWO PIECES OF REBAR in a variety of applications. It is a Type 2 rebar coupler for up to grade 80 rebar per ACI 318-19.

A high strength ductile iron coupler containing internal tapered female threads on one end and a grout cavity with an alignment aide cone on the other

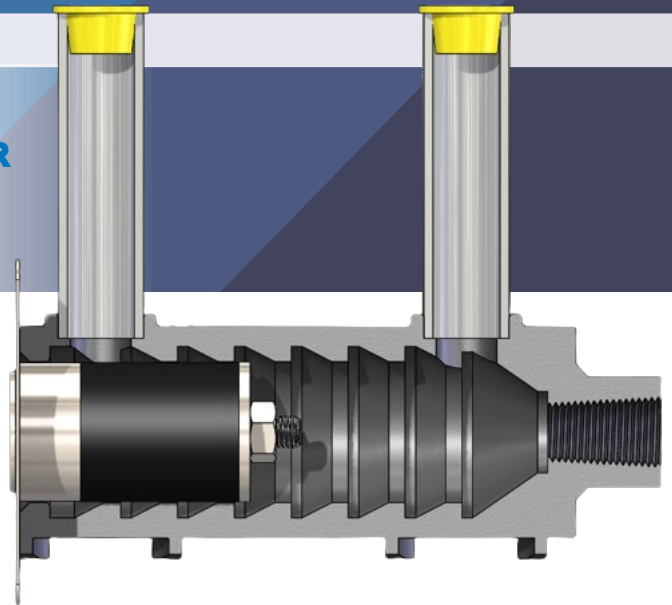
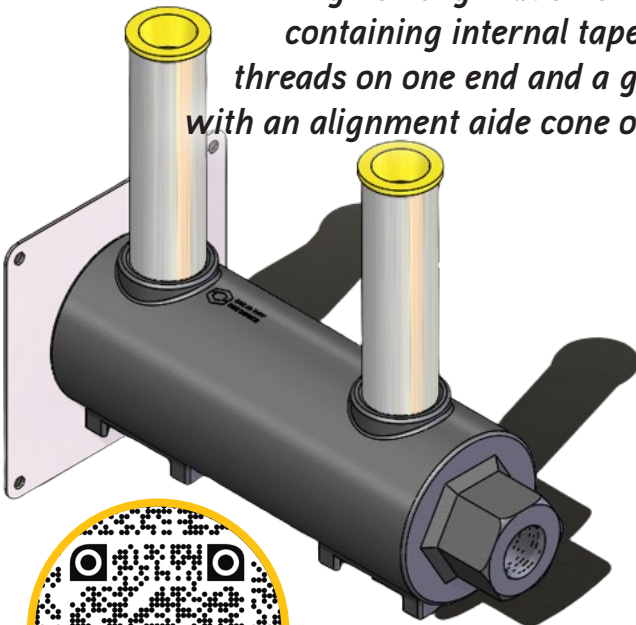

- High Strength Ductile Iron
- Couples all rebar sizes
- Oversized cavity allows for greater field tolerance
- Taper-Lock Type 2 tapered thread
- Standardized port size designed to accept 3/4" SCH40 PVC
- Integral stacking feet stabilize and assist in wire-tying, acting as a platform for rebar chair

DAYTONSUPERIOR.COM | 800-977-9600

REV. 09/24 ©2024 Dayton Superior Corporation

