

TECHNICAL DATA SHEET

DESCRIPTION

The Dayton Superior P92FEW Forged Erection Anchor is specifically designed to provide greater lifting capacities from horizontal to vertical edge lifts. The head of the anchor is designed with two protrusions or "ears" on the head of the anchor which provide protection against concrete spalling. These protrusions restrict the ring clutch rotation during lateral pulls. As a result, lateral forces are transmitted directly to the edge of the anchor instead of the concrete.

APPLICATION

The Dayton Superior P92FEW Fleet-Lift Forged Anchors are used for precast and tilt-up panel erection.

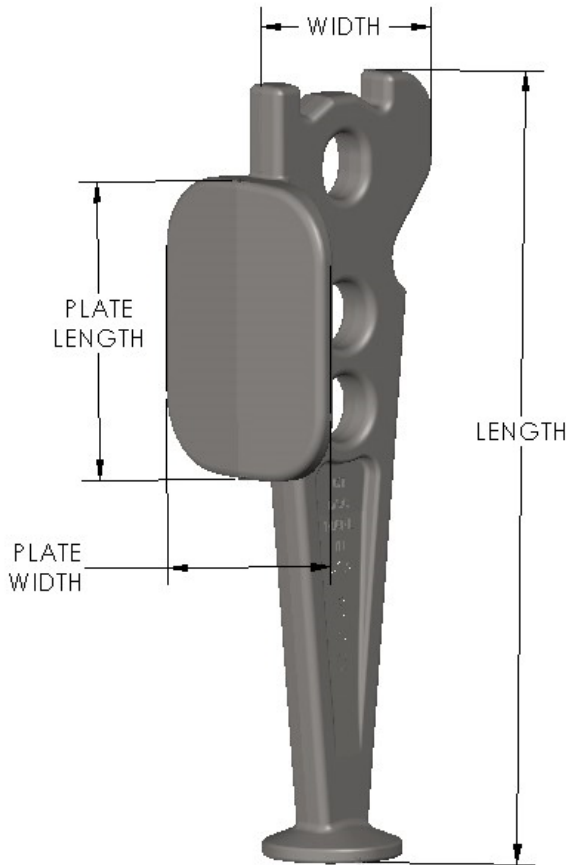

FEATURES

- Forged design creates up to 50% higher load capacity than stamped anchors which can reduce the number of anchors required.
- Forged anchors do not depend on welding or thread engagement to develop its safe working loads.

- The forged shear plate eliminates the need for a shear bar.
- Available in plain or hot dip galvanized finishes.
- Forged material have superior weathering and rain water corrosion resistance when compared to stamped anchors.
- Based on Charpy Impact Test, forged anchors have twice low temperature ductility over stamped anchors.

TECHNICAL DATA

Anchor	Length (mm)	Width (mm)	Plate Length (mm)	Plate Width (mm)	Slab Thickness (mm)	Minimum Corner Distance (mm)	Shear Safe Working Load with Shear Plate (kg)	Tension Safe Working Load Anchor Only (kg)	Tension Safe Working Load with Tension Bar (kg)							
5 Tonne x 200mm (3 Ton x 203 mm)	203	59	89	64	100	305	1,451	4,837	4,837							
					125		1,854									
					150		2,257									
					175		2,741									
					200		3,225									
					225		3,547									
					250		3,870									
					275		4,192									
300	4,596															
10 Tonne x 265 mm (6 Ton x 265 mm)	265	73	102	78	140	406	2,499	8,062	9,675							
					150		2,620	8,466								
					175		2,983	9,272								
					200		3,257	9,675								
					225		3,709	9,675								
					250		4,031	9,675								
					275		4,434	9,675								
					300		4,918	9,675								
16 Tonne x 320 mm (10 Ton x 320 mm)	320	121	102	81	190	483	3,709	14,424	16,125							
					200		3,870	15,178								
					225		4,394	15,931								
					250		4,918	16,125								
					275		5,482	16,125								
					300		6,127	16,125								
					19 Tonne x 320 mm (12 Ton x 320 mm)		320	121		102	81	190	483	3,709	14,424	18,907
												200		3,870	15,178	
225	4,394	15,931														
250	4,918	16,685														
275	5,482	17,439														
300	6,127	18,193														

1. WLL provides the industry standard 2.25:1 factor of safety in 24 Mpa normal weight concrete.
2. Anchors were tested in concrete with minimum reinforcing per ACI 318.

INSTALLATION

1. The P92FEW Anchor is set in the form with a P99 Recess Plug.

RELATED PRODUCTS

- P92FE Forged Erection Anchor
- P98T Tension Bars
- P91S Lifting Hardware
- P99 Reusable Recess Plug
- P99D Disposable Recess Plug
- P99P Patch Cap

ORDERING INFORMATION

FLEET LIFT™ FORGED ERECTION ANCHOR W/SHEAR PLATE

- MADE IN USA

Product Code	Description	Weight
143764	6 TON 265 mm PLAIN	2.11 kg
143761	10 TON 320 mm HDGALV	3.85 kg

TECHNICAL DATA SHEET**FLEET LIFT™ FORGED ERECTION ANCHOR W/SHEAR PLATE****- IMPORT**

Product Code	Description	Weight
129473	3 TON 200 mm PLAIN	0.91 kg
143424	6 TON 265 mm PLAIN	2.08 kg
100148	12 TON 320 mm PLAIN	3.76 kg
139577	3 TON 200 mm HOT DIPPED GALV.	0.91 kg
143425	6 TON 265 mm HOT DIPPED GALV.	2.40 kg
100149	12 TON 320 mm HOT DIPPED GALV.	3.76 kg

MANUFACTURER

Dayton Superior Corporation (Australia) PTY LTD
31 Metrolink Circuit
Campbellfield, VIC 3061
Australia
Australia Phone: +61 1300 DAYTON (329866)
Website: www.daytonsuperior.com.au

WARRANTY (ACCESSORIES)

Limited Warranty. Dayton warrants, for a period of 60 days from the date of shipment (three years from the date of shipment in the case of formwork, excluding any consumable Products included with such formwork), that Products and any associated application drawings and engineering services provided by Dayton ("Ancillary Services") will be free from defects in material and workmanship and, in the case of custom designed formwork, that the formwork will meet the specifications set forth in the design drawings approved by Dayton and Customer. Any claim under this warranty must be made in writing within such warranty period. If any Product and/or Ancillary Service covered by a timely claim are found to be defective, Dayton will, within a reasonable time, make any necessary repairs or corrections or, at Dayton's option, replace the Product. Unless pre-authorized by Dayton in writing, Dayton will not accept any charges for correcting defects or accept the return of any Product. This warranty will not apply to any Products that have been subjected to misuse, neglect, storage damage, misapplication, accident or any other damage caused by any person other than Dayton, or that have not been maintained in accordance with Dayton's specifications. THIS LIMITED WARRANTY IS IN LIEU OF ALL OTHER WARRANTIES AS TO THE PRODUCTS AND ANCILLARY SERVICES. DAYTON MAKES NO OTHER WARRANTIES OR GUARANTEES, EXPRESS OR IMPLIED, INCLUDING ANY WARRANTY OF MERCHANTABILITY, FITNESS FOR A PARTICULAR PURPOSE OR OTHERWISE. THE REMEDIES SET FORTH IN THIS SECTION ARE CUSTOMER'S EXCLUSIVE REMEDY FOR BREACH OF WARRANTY.