



SYMONS®
BY DAYTON SUPERIOR

DROP HEAD™ SHORING SYSTEM

INTRODUCTION

Symons® Drop Head™ System is a post and beam shoring system that consists of only 3 main components: special drop-head post shores, aluminum ledgers, and LVL joists.

Drop-heads permit easy stripping of horizontal members so they can be cycled to the next pour. Shores are reset in place as re-shores, while 75% of the total system moves to the next pour.

All parts are imperial in size and color coded to match layout drawings.

A 6' x 8' grid will support a 12-inch-thick slab. Slabs up to 18" thick can be supported with standard equipment.

All posts have attached Jet-Locks so standard steel cross braces can be used to produce a fully braced tower for safety during erection of the system. During erection, ledgers are self-suspended by one end from the drop-head, and then the other end is rotated up into position. Thus, a single worker could fully erect the posts, ledgers, and joists alone.

The system can handle cantilevers, drop beams, column capitals, and other common forming requirements, including forming of ramps. The drop head system is capable of forming ramps at grades of up to 14%.

STANDARD 4 POST LAYOUT



Universal
Drop Head

6' Red Ledger

Wood LVL Joists

Primary Post

CB Cross
Frame Spacing

QUICK INSTALL GUIDE

SYSTEM HARDWARE



Post Shores

- Primary Post
- #3 Post Shore

Height Range: 6'6" - 12'8"

*Load Range: 6,845 - 14,290 lbs.

(*Load varies by Post Height)



Wood LVL Joists

F57055 - Black - 4' & 14.5 lbs.

F57057 - Red - 6' & 18.5 lbs.



Ledgers

F57052 - Silver - 10' & 67.3 lbs.

F57051 - Green - 8' & 53.46 lbs.

F57070 - Red - 6' & 40.48 lbs.

Universal Drop Head

F57079 - 15 lbs.

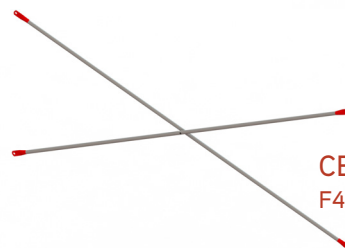
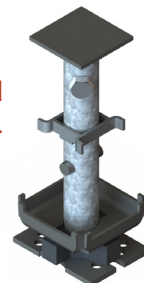

CB 48 6' Frame Spacing

F49041 - 14 lbs.

POST SHORE LOAD TABLES

HEIGHT		POST SHORE TYPE			
INCHES	FEET	PRIMARY POST	#3 POST (LBS)	Primary w/ 2' Extension	Primary w/ 3' Extension (Calculated)
78	6.5	14,290			
80	6.67	14,120			
84	7	13,785			
88	7.33	13,450			
92	7.67	13,115			
93	7.75	13,035	10,590		
96	8	12,785	10,265		
100	8.33	12,450	9,835		
102	8.5	12,280	9,620	12,285	
104	8.67	12,115	9,400	12,135	
108	9	11,780	8,970	11,845	
112	9.33	11,445	8,540	11,555	
116	9.67	11,110	8,110	11,260	
120	10	10,775	7,680	10,970	
124	10.33	10,440	7,245	10,680	
125	10.42	10,360	7,140	10,605	
128	10.67	10,110	6,815	10,385	
132	11		6,385	10,095	
136	11.33		5,955	9,805	
140	11.67		5,525	9,510	
144	12			9,220	
148	12.33			8,930	
152	12.67			8,640	
154	12.83				8,794
156	13				7,953
160	13.33				7,301
164	13.67				6,845

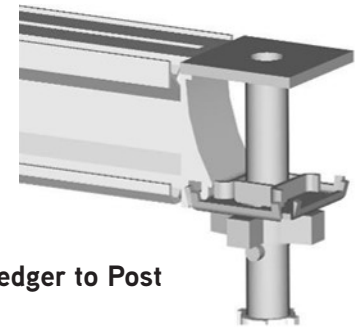
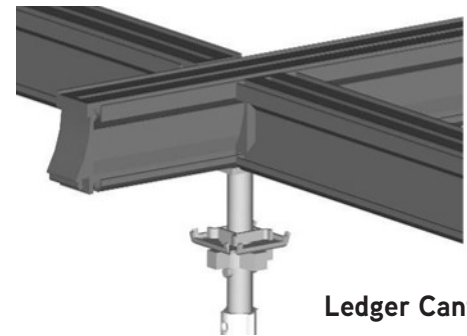
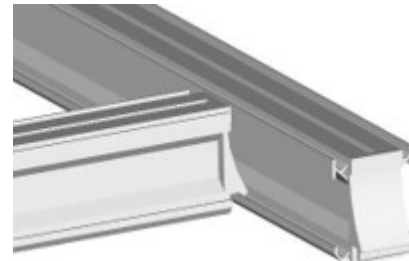
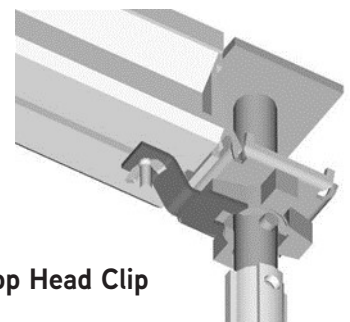
CONNECTION DETAILS

Ledger to Post

Ledger Cantilever

Ledger to Ledger

Ledger to Drop Head Clip